

# Bathroom and toilet aids



**REBOTEC®**



[www.rebotec.co.uk](http://www.rebotec.co.uk)

# Monaco / Cannes

## Shower stool

### Equipment:

- made of plastic and aluminium
- 7 adjustments in height
- approved up to 130 kg body weight

- **Monaco**

ref. no. 363.00.10

- **Cannes**

ref. no. 363.00.20

### Accessories:

- travelling-bag  
ref. no. 284.00.30



ref. no. 363.00.10



ref. no. 363.00.20

Type:	Cannes	Monaco
seat height:	42 cm - 57 cm	42 cm - 57 cm
seat width:	40 cm	40 cm
seat depth:	40 cm	40 cm
max. required space:	45 cm x 53 cm	45 cm x 45 cm
adjustments:	7 x	7 x
weight:	ca. 3,6 kg	ca. 2,8 kg
max. body weight:	130 kg	130 kg
ref. no.:	363.00.20	363.00.10

# Nizza

## Shower chair



ref. no. 363.00.30

### Equipment:

- made of plastic and aluminium
- 7 adjustments in height
- approved up to 130 kg body weight

- **Nizza**  
ref. no. 363.00.30

### Accessories:

- travelling-bag  
ref. no. 284.00.30

*Height adjustable!*

Type:	Nizza
seat height:	42 cm - 57 cm
seat width:	40 cm
seat depth:	40 cm
max. required space:	51 cm x 53 cm
adjustments:	7 x
weight:	ca. 4,8 kg
max. body weight:	130 kg
ref. no.:	363.00.30



# Turin

## Shower stool

### Equipment:

- made of plastic and aluminium
- 8 adjustments in height
- approved up to 100 kg body weight

ref. no. 368.00.20

*Height adjustable!*



ref. no. 368.00.20



Type:	Turin
seat height:	46 cm - 64 cm
seat width Ø:	32 cm
seat depth:	32 cm
max. required space:	44 cm x 44 cm
weight:	ca. 1,6 kg
max. body weight:	100 kg
ref. no.:	368.00.20

# Verona

Shower stool up to 175kg



ref. no. 368.00.30

#### Equipment:

- made of plastic and aluminium
- 7 adjustments in height
- approved up to 175 kg body weight

ref. no. 368.00.30

#### Accessoires:

- travelling-bag  
ref. no. 284.00.30

*Up to 175 kg!*



Type:	Verona
seat height:	42 cm - 57 cm
seat width Ø:	36 cm
seat depth:	36 cm
max. required space:	40 cm x 40 cm
weight:	2,6 kg
max. body weight:	175 kg
ref. no.:	368.00.30

# Lyon

## Commode chair

### Equipment:

- made of plastic and aluminium
- 7 adjustments in height
- approved up to 130 kg body weight
- incl. bucket device

- **Lyon**

**ref. no. 362.00.30**

- **Lyon**

incl. bucket

**ref. no. 362.00.31**

### Accessoires:

- travelling-bag  
ref. no. 284.00.30
- holder for disposable bags with lid  
ref.no. 304.05.10
- disposable bags with lid  
ref.no. 301.00.20



ref. no. 362.00.30



ref. no. 362.00.31

Type:	Lyon	Lyon
seat height:	42 cm - 57 cm	42 cm - 57 cm
seat width:	46 cm	46 cm
seat depth:	40 cm	40 cm
max required space:	51 cm x 59 cm	51 cm x 59 cm
adjustments:	7 x	7 x
weight:	ca. 5 kg	ca. 5 kg
max. body weight:	130 kg	130 kg
ref. no.:	362.00.30	362.00.31

# Lyon

## Commode chair



ref. no. 362.54.32

### Equipment:

- made of plastic and aluminium
- 7 adjustments in height
- approved up to 130 kg body weight
- incl. bucket
- incl. seat upholstery
- seat upholstery available in three colors

ref. no. 362. ...32

Colour	Colourcode
white/black	10
white/rubin-red	44
white/blue	54

Type:	Lyon
seat height:	42 cm - 57 cm
seat width:	46 cm
seat depth:	40 cm
max required space:	51 cm x 59 cm
adjustments:	7 x
weight:	6,6 kg
max. body weight:	130 kg
ref. no.:	362. ...32



ref. no. 362.10.32

# Brest

## Toilet frame and seat

### Equipment:

- made of plastic and aluminium
- 7 adjustments in height
- approved up to 130 kg body weight

### • Brest

ref. no. 362.00.20

### Accessoires:

- bucket  
ref. no. 301.00
- seat upholstery  
ref. no. 440. ...62
- bucket device  
ref. no. 309.00.00
- travelling-bag  
ref. no. 284.00.30
- holder for disposable bags with lid  
ref.no. 304.05.10
- disposable bags with lid  
ref.no. 301.00.20



ref. no. 362.00.20

*Available with  
a travelling bag!*

Type:	Brest
seat height:	42 cm - 57 cm
seat width:	46 cm
seat depth:	40 cm
max required space:	45 cm x 59 cm
adjustments:	7 x
weight:	ca. 3,8 kg
max. body weight:	130 kg
ref. no.:	362.00.20



# Cascade

Grab rail



## Equipment:

- synthetic material
- ergonomically shaped
- versatile adaptable:  
horizontal, vertical, diagonal
- fitted with rose fixings
- endless expandable

ref. no. 601.05.00

*solid - flexible  
Endless expandable!*



# Swing

## Grab rail

### Equipment:

- plastic and aluminium
- ergonomically shaped
- different lengths
- fitted with rose fixings

*More safety!*

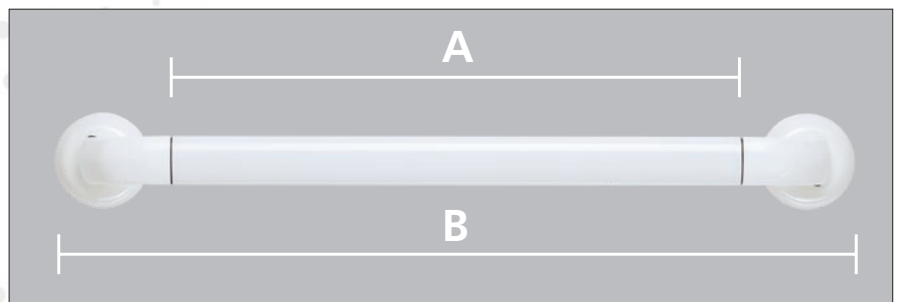
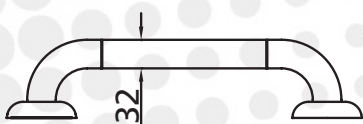
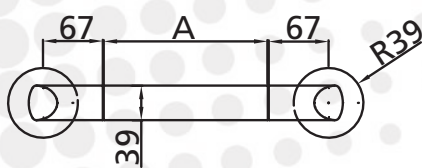

Type:	60s	75s	90s	105s
tangible length A:	45 cm	60 cm	75 cm	90 cm
total length B:	67 cm	82 cm	97 cm	112 cm
ref. no.:	604.05.45	604.05.60	604.05.75	604.05.90



**1. Travelling-bag**  
ref. no. 284.00.30



Colour	Colourcode
black	10
rubin-red	44
blue	50

**2. Seat cushion**  
ref. no. 440. ...62



Colour	Colourcode
grey	00
rubin-red	44

**3. Bucket**

- suitable for all commode chairs and shower chairs
- ref. no. 301. ...



**4. Holder for disposable bags with lid**

- incl. 3 disposable bags with lid
- ref. no. 304.05.10



**5. Disposable bags with lid**  
ref. no. 301.00.20